

API Standard Triple Eccentric Flanged Butterfly Valve

Product Description

Name	Description
Model	D343H/W-150LB/300LB/600LB
Name	Triple Eccentric Flanged Butterfly Valve
Size	DN50-1400
Pressure	150LB/300LB/600LB
Temp.	-29~425°C
Suitable Medium	Water, weak acid base, air, steam, oil, etc.
Body	WCB/CF3/CF3M/CF8/CF8M
Seat	13Cr/304/316
Disc	WCB/CF3/CF3M/CF8/CF8M
Shaft	2Cr13/304/316
Actuator	Worm Gear/Electric/Pneumatic

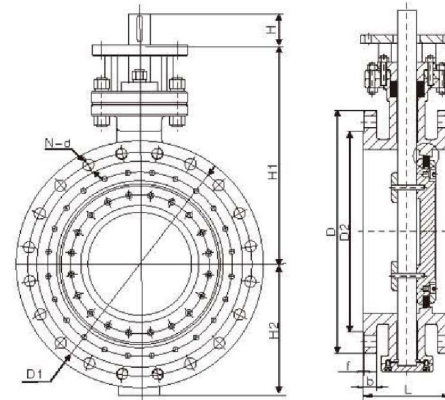

Executive Standard

Name	Standard
Design and Manufacture	API 609
Face to face Length	API 609
End Flange	ASME B16.5, ASME B16.47-B
Pressure Test	API 598

Dimensions

Size		150LB						
DN	NPS(Inch)	L	D	D1	D2	b	f	N-d
50	2"	108	150	120.5	92	18	2	4-19
65	2 1/2"	112	180	139.7	105	18	2	4-19
80	3"	114	190	152.5	127	22	2	4-19
100	4"	127	230	190.5	157	24	2	8-19
125	5"	140	255	216	186	24	2	8-22
150	6"	140	280	241.5	216	26	2	8-22
200	8"	152	345	295.5	270	29	2	8-22
250	10"	165	405	362	324	31	2	12-25
300	12"	178	485	432	381	32	2	12-25
350	14"	190	535	476	413	35	2	12-29
400	16"	216	595	540	470	37	2	16-29
450	18"	222	635	578	533	40	2	16-32
500	20"	229	700	635	584	43	2	20-32
600	24"	267	815	749.5	692	48	2	20-35
700	28"	292	835	795.3	762	43.7	2	44-22
800	32"	318	940	900.1	864	45.3	2	48-22
900	36"	330	1055	1009.6	972	51.5	2	44-26
1000	40"	410	1175	1120.8	1080	54.8	2	44-30
1200	48"	470	1390	1335.1	1289	64	2	44-33
1400	56"	530	1600	1543	1492	72	2	60-33